



InGaAs PIN Photodiode

Type: PDS363-OT-a02

Electro-optical Characteristics(T=25):

| Parameters | Symbol | Test Conditions | Min. | Typ. | Max. | Unit |
|-----------------------------|-----------|-----------------|------|------|------|---------|
| Wavelength | | | 1000 | | 1650 | nm |
| Dark Current | I_D | $E_c=0, -0.1V$ | | 2 | 5 | nA |
| Responsivity(Unattenuation) | R_e | 1310nm | 0.85 | 0.90 | | A/W |
| Attenuation | | | | 20 | | dB |
| Active diameter | | | | 1500 | | μm |
| Operating Voltage | V_{opr} | | | -1 | -3 | V |

Absolute maximum ratings:

| Parameters | Symbol | Value | Unit |
|-----------------------------|-----------|---------|------|
| Reverse Voltage | V_R | 10 | V |
| Reverse Current | | 5 | mA |
| Forward Current | I_P | 10 | mA |
| Operating Temperature Range | T_{opr} | -40—+85 | |
| Storage Temperature Range | T_{stg} | -40—+85 | |
| Lead Solder Temperature | | 260 | |

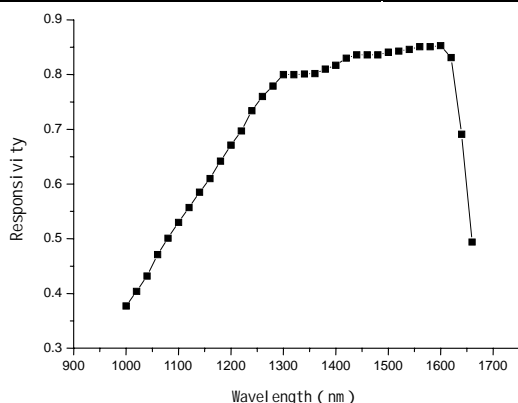

Spectrum Curve

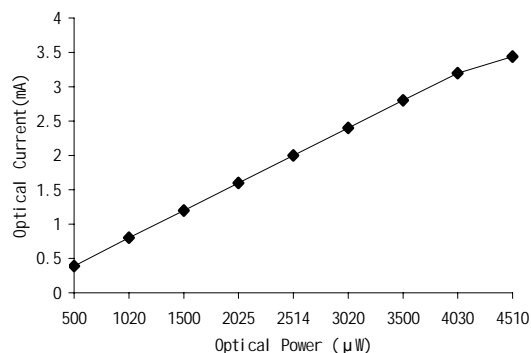

Current-Optical Power Curve

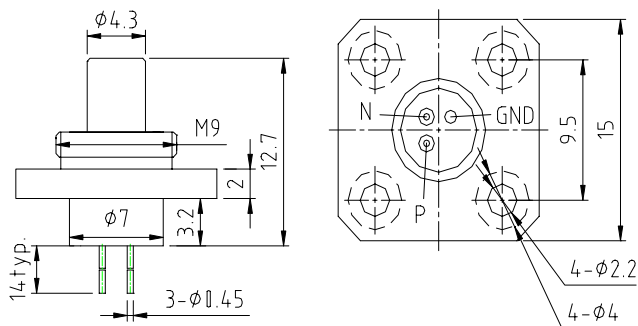

Package Dimensions (mm)

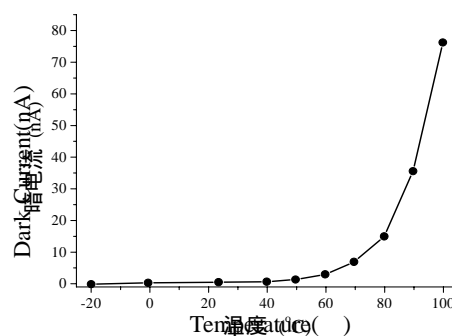

Dark Current-Temperature Curve

Features: The large active area chip of the InGaAs photodiode guarantees the testing coincidence; suits for kinds of connectors testing, such as SC, FC, ST, etc.

Precautions: ESD protection is imperative.